

# SPHERES 2009

24 OCTOBRE 2009 - 30 MAI 2010  
www.galleriacontinua.com

AIR DE PARIS  
GALLERIA CONTINUA  
GOODMAN GALLERY  
GALERIE KRINZINGER  
KAMEL MENNOUR  
ALMINE RECH GALLERY  
ESTHER SCHIPPER

## LONG TERM PROJECTS

Galleria Continua aime maintenir une continuité entre ses expositions passées, présentes et futures. C'est pourquoi certaines oeuvres présentées font écho aux expositions passées.

Galleria Continua appreciates to maintain a continuity between past, present and future exhibitions. In this connection, some works evoke past exhibitions.

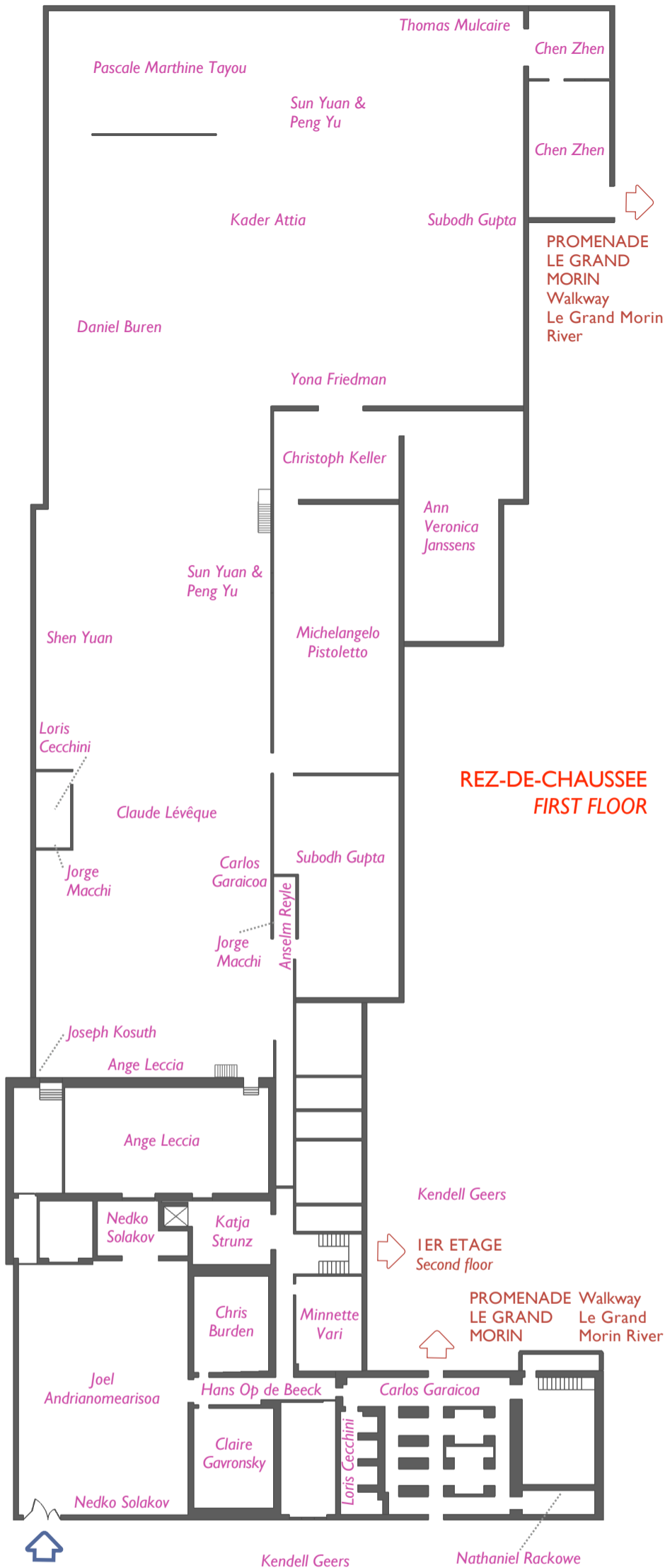

## IER ETAGE SECOND FLOOR

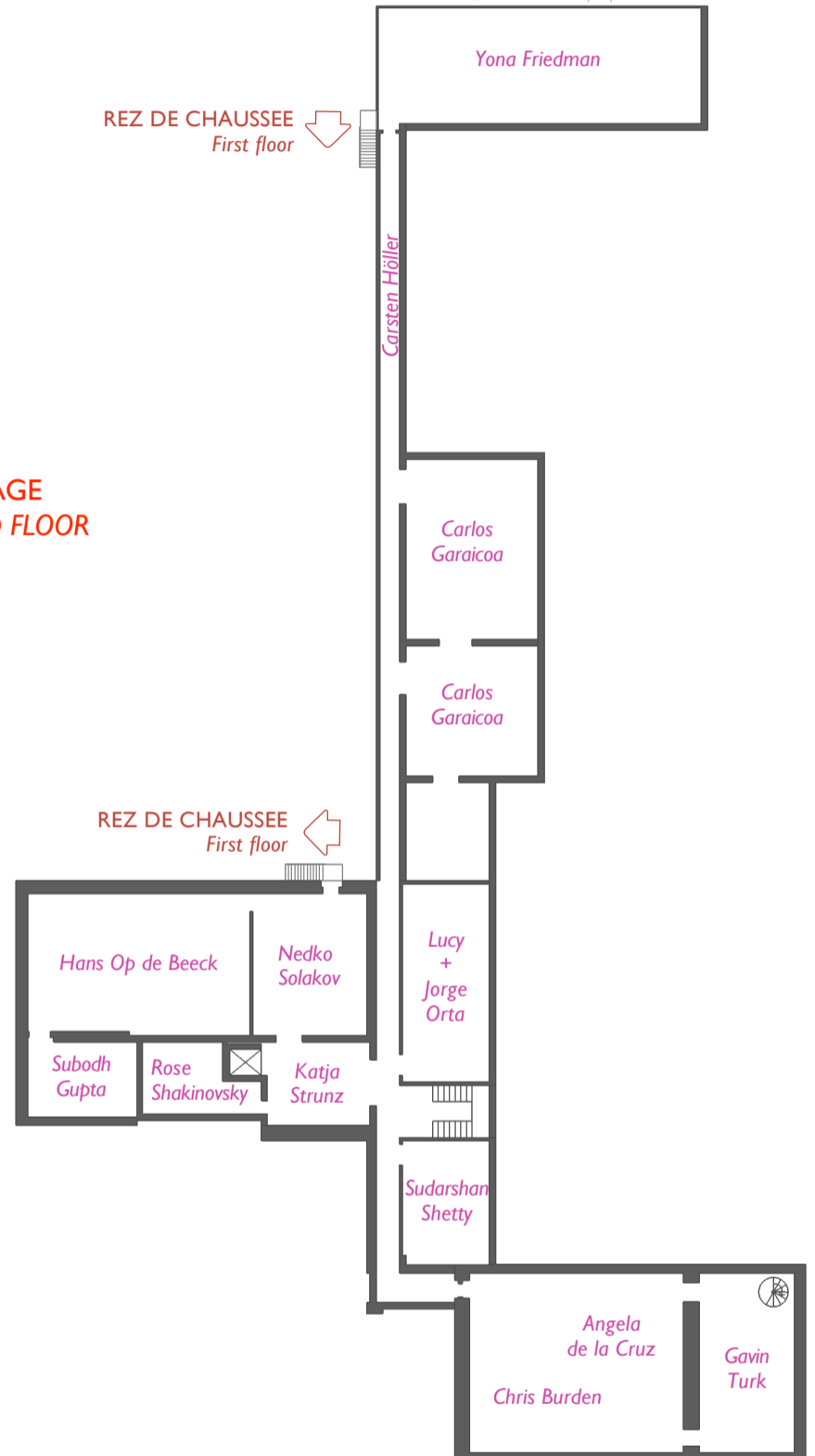

Kendell Geers

**ENTREE**  
Entrance

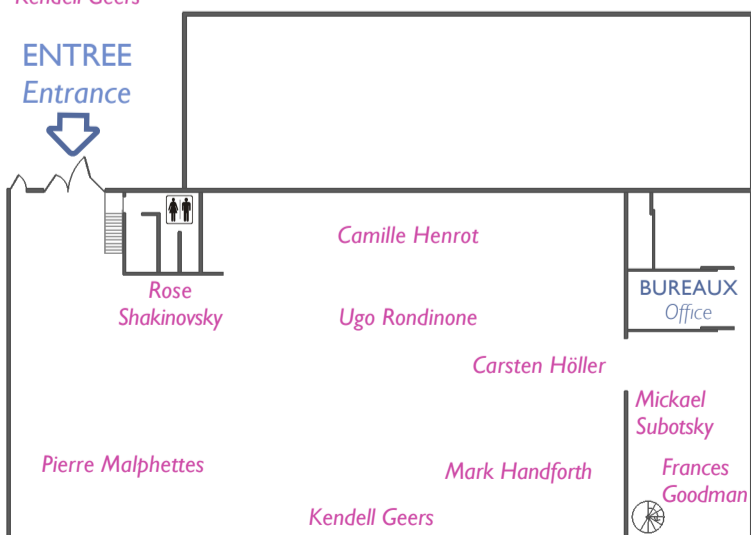

Kendell Geers

Pascale Marthine Tayou

Willem Boshoff

